



Blower Wheel Issues

Are you experiencing a 'grinding' sound during the operation of your Magic Lung blower motor? Have you recently removed your blower wheel for cleaning and it doesn't sound the same when you put it back on? If so this simple tip & trick could save you some headaches and a service call.

Every VentAhood Magic Lung blower system has a specially designed blower wheel that is integral part of the grease extraction. The blower wheels are attached to the motor by a set screw. If this screw is not tightened properly it can cause the blower wheel to rattle while in operation. Please see the instruction and illustration below explaining how to properly tighten the set screw as well as the removal & reinstallation of the Magic Lung blower wheel.

Tightening the Set Screw

Tools Required

- *1/8 T-Handle Allen Key*

Step 1 - Removing the Housing

You will need to remove the EZ clean grease shield. Then you will undo the 2 clasps holding the blower housing in place. Then simply pull the housing towards and down once it passes the blower wheels. (See Fig. 1)

Step 2 – Locate the Set Screw

The set screw is located in the middle of the blower wheel. The way to access the set screw is through the fins of the blower wheel. (See Fig. 2)

Step 3 – Tighten the Set Screw

You will need to take your 1/8 T-Handle Allen Key and insert it into the set screw through the blower wheel (See Fig. 3). Once the Allen Key is in place you will tighten the set screw by twisting clockwise. There should no longer be a 'grinding' sound anymore.

How to Uninstall your Blower Wheel

Tools Required

- *1/8 T-Handle Allen Key*

Step 1 - Removing the Housing

You will need to remove the EZ clean grease shield. Then you will undo the 2 clasps holding the blower housing in place. Then simply pull the housing towards and down once it passes the blower wheels. (See Fig. 1)

Step 2 – Locating the Set Screw

The set screw is located in the middle of the blower wheel. The way to access the set screw is through the fins of the blower wheel. (See Fig. 2)

Step 3 – Releasing the Set Screw

You will need to take your 1/8 T-Handle Allen Key and insert it into the set screw through the blower wheel. (See Fig. 3) Once the Allen Key is in place you will release the set screw by twisting counter-clockwise. The set screw may be very tight, you will need to apply enough pressure to release it. You will know the set screw has released once you hear a ‘pop’ from the set screw releasing from the motor shaft. Remove the blower wheel for cleaning.

Re-Installing the Blower Wheel

To re-install the blower wheel simply slide the blower wheel back onto the motor shaft. It is imperative that you line the set screw up with the flat part of the blower motor shaft. Insert your Allen key and tighten the set screw tightly to the motor shaft.

Note: If there is a grinding sound after re-installation you need to further tighten the set screw

Fig 1 – Blower Housing Removal

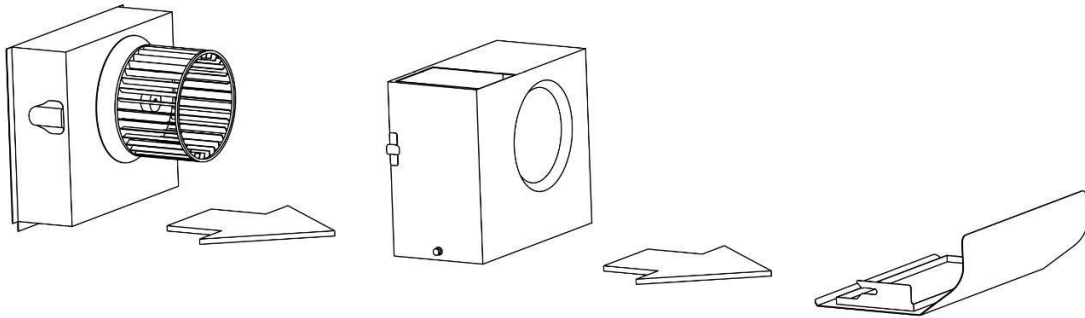

To remove the blower housing(s) and damper(s), first remove the E-Z Clean blower shield. The blower housing is removed for cleaning by unsnapping the suitcase latches (one on each side of the housing). Then, pull the housing forward and gently “tip” it downward to clear the blower wheel(s).

Fig 2 – Set Screw Location



Fig 3 – Allen Key Insertion

